

# Industry-Relay SGR S36GL

# Miniature – Industry-Relay 2 pole / 4 pole 5A

# ELESTA

## Technical Data

Contact Data		
Type of Contact	Single Contact	
No. of Contacts	2C / 4C	
Max. Switching Voltage	VAC / VDC	250 / 125
Rated Current	A	5
Switching Load (Min.)	VDC / mA	10 / 10
Contact Material	AgNi, AgNi + htv,	

General Data		
Mechanical Life	> Operations	$1 \times 10^7$
Electrical Life at Rated Voltage	> Operations	$1 \times 10^5$
Operate Time / Release Time	approx. in ms	25 / 25
Test Voltage Contact / Coil	$\geq VAC_{eff}$	1500
Test Voltage Contact Open	$\geq VAC_{eff}$	1000
Ambient Temperature	°C	-55...+70
Approvals	C-UL, TÜV	
Weight	gr.	37

Coil at +20°C		
Rated Voltage	VDC	6...110
Rated Voltage	VAC	6...240
Power Consumption (DC - Coil)	approx. W	0,9
Power Consumption (AC - Coil)	approx. VA	1,2

DC-Coil (0,9 W)				
$U_N$ (V)	R (Ohm)	$U_{AN}$ (V)	$U_{AB}$ (V)	$I_N$ (mA)
6	$40 \pm 10\%$	$\leq 4,8$	$\geq 0,6$	150,0
12	$160 \pm 10\%$	$\leq 9,6$	$\geq 1,2$	75,0
24	$650 \pm 10\%$	$\leq 19,2$	$\geq 2,4$	36,9
36	$1500 \pm 10\%$	$\leq 28,8$	$\geq 3,6$	24,5
48	$2.600 \pm 10\%$	$\leq 38,4$	$\geq 4,8$	18,5
110	$11.000 \pm 10\%$	$\leq 88,0$	$\geq 11,0$	10,0

AC-Coil (1,2 VA)				
$U_N$ (V)	R (Ohm)	$U_{AN}$ (V)	$U_{AB}$ (V)	$I_N$ (mA)
6	$11,5 \pm 10\%$	$\leq 4,8$	$\geq 1,8$	234,0
12	$46,0 \pm 10\%$	$\leq 9,6$	$\geq 3,6$	117,0
24	$184,0 \pm 10\%$	$\leq 19,2$	$\geq 7,2$	58,5
36	$370,0 \pm 10\%$	$\leq 28,8$	$\geq 10,8$	39,0
48	$735,0 \pm 10\%$	$\leq 38,4$	$\geq 14,4$	28,0
120	$4550,0 \pm 10\%$	$\leq 96,0$	$\geq 36,0$	14,1
220/240	$14400,0 \pm 10\%$	$\leq 176,0$	$\geq 72,0$	11,4

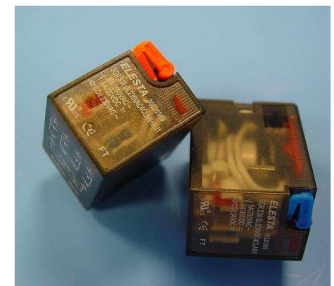

## Dimension Diagram

2pole / with soldering lugs / pluggable

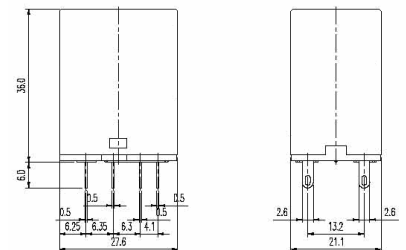

2pole / printable

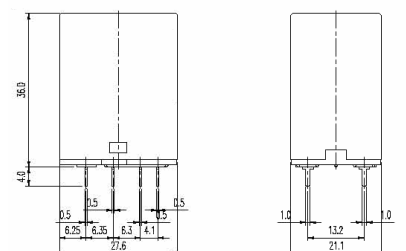

4pole / with soldering lugs / pluggable

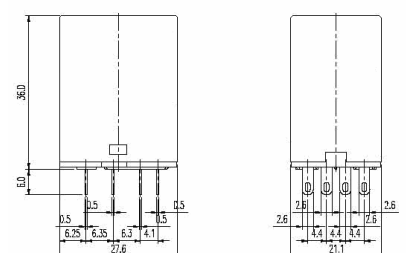

4pole / printable

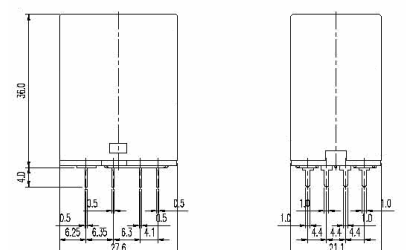

All measure in mm.

**Order Type**

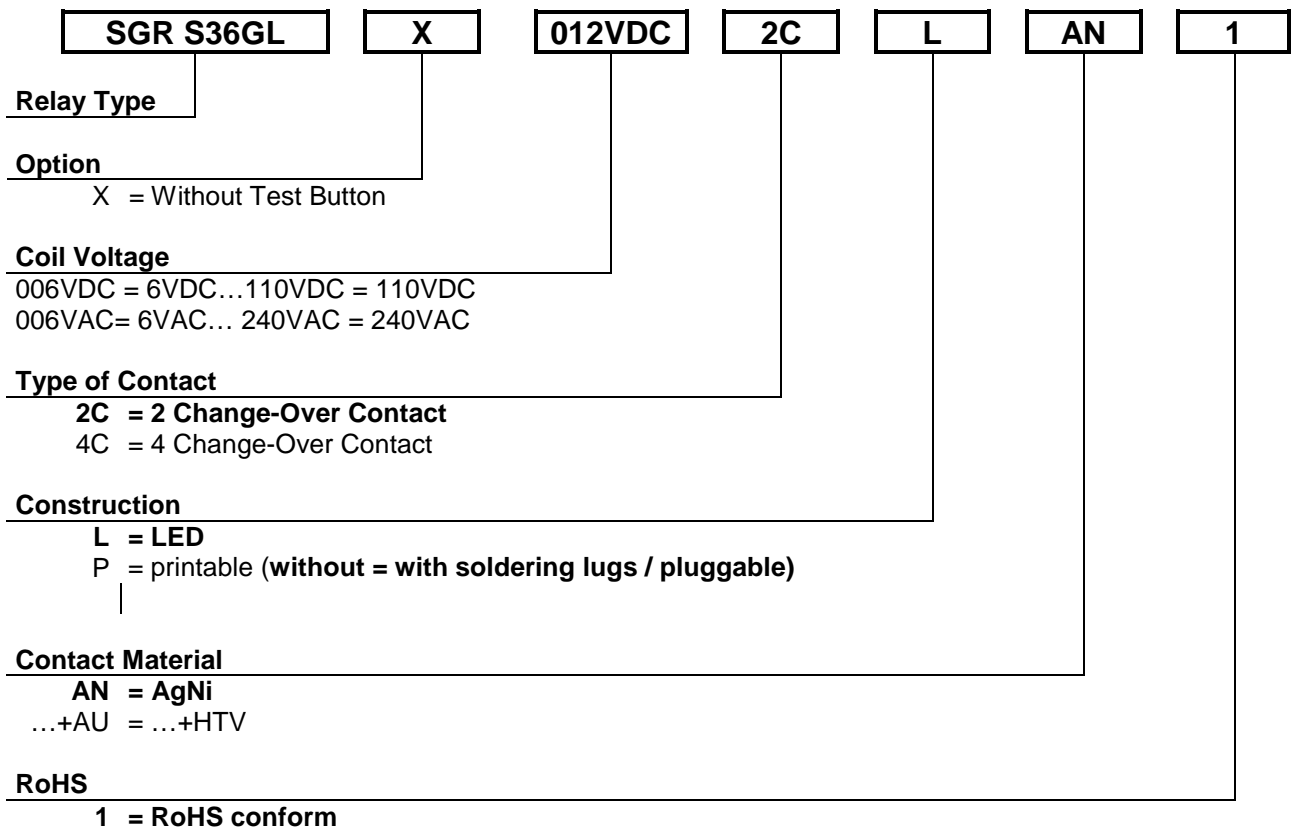

**Schematic Diagram**

2pole / with soldering lugs / pluggable

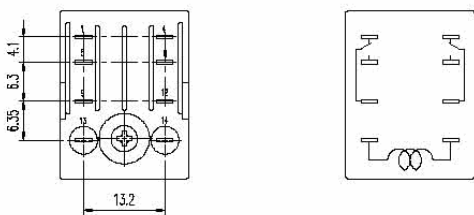

2pole / printable

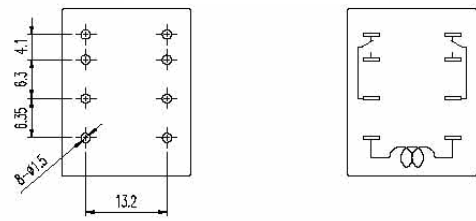

4pole / with soldering lugs / pluggable

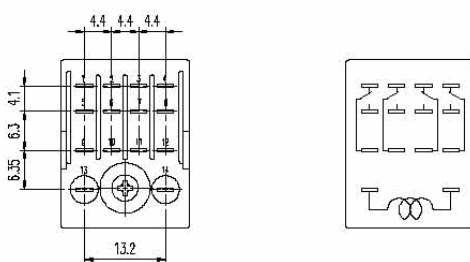

4pole / printable

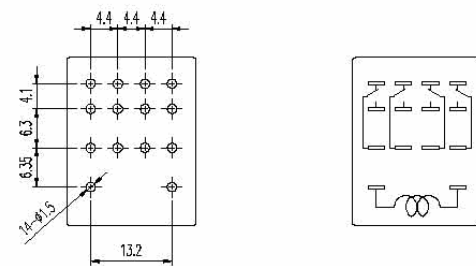

View on circuit points. All measure in mm.